

DELHI MATHURA ROAD TO DELHI

**OCCUPANCY CALCULATION**  
 TOTAL F.A.R. GROUND TO FIFTEENTH FLOOR  
 82007.553 SQ.M. (EXCLUDING BASEMENTS)  
 GROSS AREA PER PERSON IN I.T. BUILDING=10  
 = 82007.553 / 10 = 8200.75 PERSON

**AREA CALCULATION:**  
 PLOT AREA = 8.24 ACRES [33346.04 SQ.M.]  
 PERM.GROUND COVERAGE 40% = 13338.416 SQ.M.  
 COOMERCIAL @ 4% = 1333.840 SQ.M. (of balance)  
 F.A.R. FOR COMMERCIAL @ 150 = 2000.762 SQ.M.  
 F.A.R. FOR IIT @ 250 = 8000.905 SQ.M. (of actual area)  
 TOTAL PERMISSIBLE F.A.R. = 82007.553 SQ.M. (2000.762 + 8000.905)  
 = 82007.553 SQ.M.

**PROPOSED GROUND COVERAGE [SQ.M.] STILT LVL.]**

BLOCK	A	B	C	D	TOTAL
COVD. AREA	4583.608	5011.803	1481.05	2247.38	13323.819 SQ.M.

PROPOSED F.A.R.	A	B	C	TOTAL
[STILT FLOOR-1]	179.961	284.928	60.971	495.86 SQ.M.
[STILT FLOOR-2]	179.961	284.928	60.971	495.86 SQ.M.
GROUND FLOOR	2862.453	3071.008	977.84	6911.301
FIRST FLOOR	2862.453	3071.008	977.84	6911.301
SECOND FLOOR	2862.453	3071.008	977.84	6911.301
THIRD FLOOR	2862.453	3071.008	977.84	6911.301
FOURTH FLOOR	2862.453	3071.008	977.84	6911.301
FIFTH FLOOR	2862.453	3071.008	977.84	6911.301
SIXTH FLOOR	2862.453	3071.008	977.84	6911.301
SEVENTH FLOOR	2862.453	3071.008	977.84	6911.301
EIGHT FLOOR	2862.453	3071.008	977.84	6911.301
NINTH FLOOR	2862.453	3071.008	977.84	6911.301
TENTH FLOOR	2862.453	3071.008	977.84	6911.301
ELEVENTH FLOOR	2862.453	3071.008	977.84	6911.301
TWELFTH FLOOR	2862.453	3071.008	977.84	6911.301
THIRTEENTH FLOOR	2862.453	3071.008	977.84	6911.301
FOURTEENTH FLOOR	2862.453	3071.008	977.84	6911.301
FIFTEENTH FLOOR	2862.453	3071.008	977.84	6911.301
TOTAL F.A.R.	46159.17	32792.531	3055.462	82007.553

TOTAL F.A.R. GROUND TO FIFTEENTH FLOOR  
 82007.553 SQ.M. (EXCLUDING BASEMENTS)

**NOTES:**

1. AUTOMATIC DETECTOR SYSTEM SHALL BE PROVIDED AS PER N.B.C.
2. AUTOMATIC ALARM SYSTEM SHALL BE N.B.C.
3. SEPARATE DUCT SHALL BE PROVIDED FOR ELECTRICAL FITTING AND FIRE FIGHTING INSULATION.
4. FIRE ESCAPE STAIRCASE SHALL BE 2 HOURS FIRE RATING.
5. ENTIRE BUILDING SHALL BE AUTOMATIC SPRINKLERED 6.U/G WATER TANK OF 20000LTS.
7. TERRACE TANK OF 20000 LITS.
8. TWO ELECTRICAL AND ONE DIESEL PUMP OF 2850 L.P.M AND ONE ELECTRIC PUMP OF 180 L.P.M.
9. INTERNAL STAIRCASE SHALL BE AS PER N.B.C CLOSURE @ 4.5.
10. REFUGEE AREA SHALL BE PROVIDED AS PER N.B.C
11. ALL FIRE PROTECTION SYSTEM SHALL BE AS PER N.B.C. AND FIRE FIGHTING EQUIPMENT SHALL BE OF 1.5.1-MARKED.

**BASEMENT COVERAGE DETAIL**

BLOCK	A	B	C	D	TOTAL
THIRD BAS.					2655.689 2655.689 SQ.M.
SEC. BAS.	6861.129	5826.70	1879.429		2655.689 17021.947 SQ.M.
FIRST BAS.	6861.129	5826.70	1879.429		2655.689 17021.947 SQ.M.
TOTAL	13722.258	11653.40	3758.858		7867.067 36702.467 SQ.M.

**BLOCK-B (MULTI LEVEL PARKING) MECHANICAL PARKING FLOORS AREAS DETAIL**

FLOOR	AREAS DETAIL
GROUND FLOOR	2247.36 SQ.M.
FIRST FLOOR	2247.36 SQ.M.
SECOND FLOOR	2247.36 SQ.M.
THIRD FLOOR	2247.36 SQ.M.
FOURTH FLOOR	2247.36 SQ.M.
TOTAL	11236.80 SQ.M.

ALL FLOOR COVD. AREA (INCLUDING BASEMENTS+STILT +MULTI LEVEL PARKING FLOORS) THAT IS  
 = 13323.818 SQ.M. + 82007.553 + 36702.467 + 11236.80 = 143270.638 SQ.M. (13323.818 + 82007.553 + 36702.467 + 11236.80)  
 = 143270.638 SQ.M. (13323.818 + 82007.553 + 36702.467 + 11236.80)  
 = 143270.638 SQ.M.

**PARKING CALCULATION**  
 TOTAL FAR = 82007.553 SQ.M.  
 REQUIRED PARKING @ 40 SQ.M. OF COVD. AREA = 82007.553 / 40 = 2050.587 OR 2051 E.CS

**PROPOSED CAR PARKING**  
 THIRD BASEMENT AREA = 2655.689 (MINUS 15% AREA FOR SERVICES) = 2257.335 SQ.M. = 64.56 OR 65 NOS.  
 SECOND BASEMENT AREA = 17021.947 (MINUS 15% AREA FOR SERVICES) = 14468.654 SQ.M. = 413.52 OR 413 NOS.  
 FIRST BASEMENT AREA = 17021.947 (MINUS 15% AREA FOR SERVICES) = 14468.654 SQ.M. = 413.52 OR 413 NOS.  
 STILT LEVEL = 2247.36 SQ.M. = 738.90 OR 739 NOS.  
 MULTI LEVEL PARKING = 11236.80 SQ.M. = 374.56 OR 375 NOS.  
 SURFACE PAR. = 11236.80 SQ.M. = 374.56 OR 375 NOS.

TOTAL PROPOSED PARKING = 65 + 413 + 413 + 739 + 375 + 115 = 2120 NOS.

PROPOSED AREA IN COMM. = 1477.048 SQ.M.  
 PROPOSED AREA IN I.T. (FAR) = 82007.553 - 1477.048 = 80530.505 SQ.M.  
 COMM. AREA DEPTH = GRD FLOOR = 9.54 - 0.82 = 8.72 M.  
 FIRST FLOOR = 10.82 - 1.66 = 9.16 M.  
 1477.048 SQ.M.

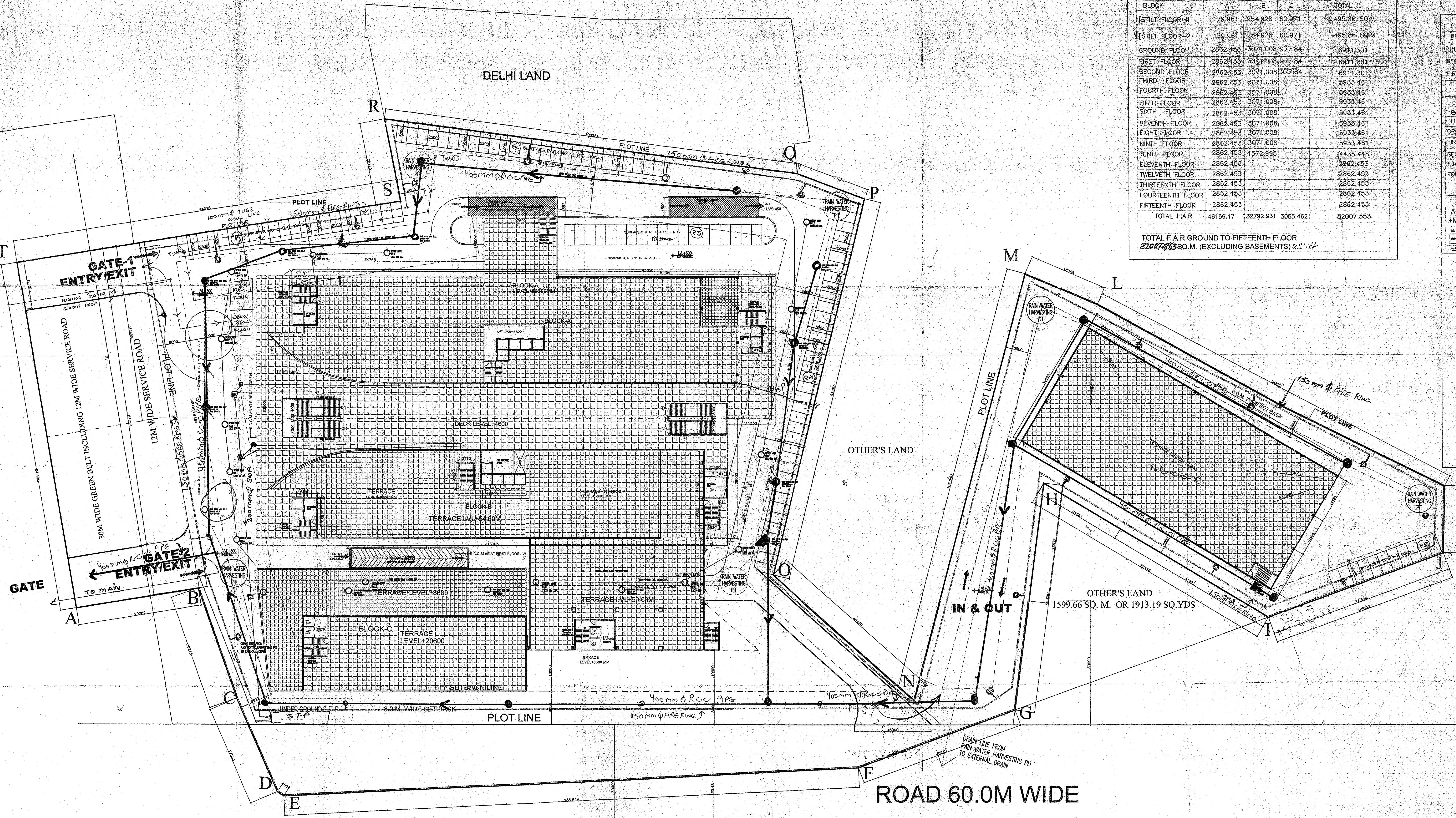

**OWNERS SEAL & SIGNATURE**  
 M/S. DOVE INFRASTRUCTURE PVT. LTD.  
 [Signature]

**ARCHITECTS SEAL & SIGNATURE**  
 [Signature]

Checked and found ok for Public Health (Sanitary) Services and Fire Protection in accordance with the provisions of the Delhi Building Rules, 1996.  
 [Signature]  
 Superintending Engineer (HQ) HUDA, Panchsukla  
 [Signature]  
 PRADEEP SEHARMA  
 CA 92/13354

**PROJECT:**  
 I.T PARK MEASURING 8.5 ACES IN REVENUE ESTATE OF VILLAGE ANANGPUR, TEHSIL AND DISTRICT FARIDABAD, HARYANA. BELONGS TO M/S. DOVE INFRASTRUCTURE PVT. LTD.

**SANCTIONED**  
 To be read in conjunction with the drawing no. 01/2009  
**FOR:** M/S. DOVE INFRASTRUCTURE PVT. LTD.  
**DRAWING TITLE:**  
**SITE PLAN**  
 DATE: APRIL-2009 DRAWING NO: 01  
 SCALE: 1:400

AT MATHURA ROAD, FARIDABAD